

FJORDBLINK

Welcoming Water

PROFESSIONAL · PEACE OF MIND

With FJORDBLINK® Birth Pool - Welcoming Water



FJORDBLINK® BIRTH POOL IS A PROFESSIONAL WORKING TOOL

From bathtubs to medical equipment From furniture to professional tools

As a healthcare professional, it is important that you are comfortable with the products you use during the birth. This applies when you offer the person giving birth pain relief in water, as well as when you assist in the water birth.

Fjordblink has specialised in producing world-class birth pools for 25 years. Our products are produced according to quality standard EN ISO:13485 for medical devices. It is your guarantee that the products comply with detailed safety and quality requirements, and therefore the products are of high quality.

Working with midwives from the outset has been crucial in ensuring that our Birth Pools and Supply Columns are now used and sold in many countries. We always respect our customers' professionalism and let it be the starting point for our product development. Knowledge sharing and user involvement are key to our success both nationally and internationally.

The Birth Pools are manufactured and hand-assembled in Denmark. We have created a sustainable product that can last for years, despite daily use in busy delivery rooms. We continue, and our mission is to make Birth Pools where user-friendly design is combined with the very highest standards.

Fjordblink has created a stylish Birth Pool with a focus on comfort, ergonomics, flexibility, mobility and safety in your maternity ward or clinic.

Developed in collaboration with international midwives with the aim of creating an optimal working tool for the professional Maternity Ward/Maternity Clinic.

- FRONT - BACK
- TURN - ROTATE
- MOVE AROUND - MOVE AWAY
- RAISE - LOWER
- There are many possibilities



"AQUADURAL" - THE TERM FOR THE PAIN-RELIEVING AND BENEFICIAL EFFECT OF WATER

Water birth or relief of birth pains in water



The Birth Pool allows the person giving birth to have relief, move, rest and relax through the stages of labour. Recent research concludes once again that a water birth is safe for the person giving birth and the baby. The research also highlights that water births contribute to a better birth experience. At Fjordblink, we welcome the good birth experiences in water, and therefore you will find "Welcoming Water" in our logo.

A professional tool where design also optimises your work area

Assisting around a Birth Pool can be challenging for the ergonomics of the healthcare professional. We have solved this by fitting a silent lifting/lowering system to the Birth Pool, so you can steplessly adjust the height to your optimum working position. A FJORDBLINK® solution developed to prevent uncomfortable and stressful assisting positions when working around the pool.



The rounded edges of the Birth Pool make it comfortable to rest on the edge.

The stability of the pool makes it safe and comfortable to lean against.



The side panels surrounding the Birth Pool are specially designed to allow room for your knees and feet.

If the Supply Column is mounted free standing in the middle of a room, this gives you 360 degree unobstructed movement around the Birth Pool.



WELL THOUGHT-OUT DESIGN PROVIDES GREATER COMFORT AND FLEXIBILITY

Spaciousness in the pool is the be-all and end-all

The Birth Pool should invite alternating, comfortable resting and/or birth positions. Integrated sitting and resting surfaces, as well as footrests and a non-slip base, further serve to support and comfort the person giving birth.

The person giving birth is free to choose whether to lie, sit, squat or kneel.



LARGE OR SMALL - WHAT SIZE FITS?

FJORDBLINK® Birth Pools are available in two sizes

The MILIEU model is our large pool and the COMFORT model is our small pool. Same design and comfort just 15% difference between dimensions.

As the Birth Pool is mobile, you can offer the size of Birth Pool that best suits the person giving birth the time. The wheels on the Birth Pool make it possible to roll the specific size Birth Pool that you need into the room.



Birth Pool dimensions

| | Model MILIEU/Large | Model COMFORT/Small |
|------------------------|--------------------|---------------------|
| External width | 1.970 mm | 1.700 mm |
| internal length | 1.130 mm | 995 mm |
| Internal width | 1.820 mm | 1.550 mm |
| Water depth | 1.010 mm | 850 mm |
| Lowest setting | 570 mm | 510 mm |
| Highest setting | 520 mm | 445 mm |

Birth Pool weight

| | | |
|--|--------------------|--------------------|
| | 166 kg | 152 kg |
| | Ca. 520 L = 686 kg | Ca. 310 L = 462 kg |

FLEXIBLE BIRTH POOL ON WHEELS - NO MORE SHORTCOMINGS WITH THE BIRTH POOL

Transform the delivery room for your current purpose

Now you do not have to explain to a person giving birth that it is impossible to access a Birth Pool because someone else is using the very delivery room where there is a fixed Birth Pool. Just pick up the size of Birth Pool that you require and roll it into the room.

If you need to use the floor space in the delivery room for other purposes, you can simply move the Birth Pool to the wall or out of the delivery room altogether. The fact that you can push the Birth Pool to the side also makes cleaning easier.

FJORDBLINK® Birth Pools have built-in castors that are activated on the Supply Column's control panel or via the handheld remote control. It gives you flexibility in the delivery room. The castors are retracted when the pool is in use. This makes it completely stable on the ground when working around the pool.



If the Birth Pool is to be moved/relocated from one room to another room, the door opening must have an internal dimension in the doorframe of at least 1,200 mm - then both sizes of Birth Pool fits through the door opening.

ONE BIRTH POOL CAN SERVICE SEVEREL ROOMS

The practical choice on wheels

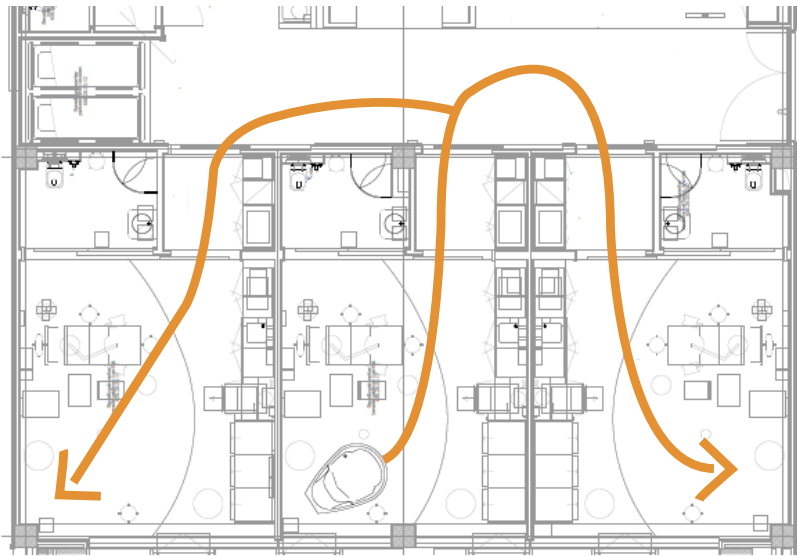

This requires that you have fitted a FJORDBLINK® Supply Column in the delivery room. It acts as a docking station for the Birth Pool. The docking station supplies the Birth Pool with electricity and water.

You can choose to install a supply column in several delivery rooms that share a Birth Pool. The Birth Pool easily disconnects from the supply column and drain and can therefore be moved from room to room. Put the pool on wheels and take it exactly where you need it.

FJORDBLINK® SUPPLY COLUMN IS THE BIRTH POOL'S DOCKING STATION

A unique and modern product solution that solves several challenges

The associated Supply Column supplies the Birth Pool with water and electricity. It also acts as the Birth Pool's docking station, because you can operate all the Birth Pool features from the Supply Column.

The Supply Column comes in 3 models, so the position of the pool in the room can be optimised. Water and electricity can be supplied to the Supply Column via the floor or wall. Drainage can be via the Supply Column, or it can be placed externally under the Birth Pool.

Operating functions on the Supply Column:

- Open/close drainage system
- Water filling
- Shower function
- Temperature adjustment
- Water pressure adjustment
- Activating the lifting/lowering system
- Activate wheels/castors



3 MODELS OF SUPPLY COLUMNS - SAME BUT DIFFERENT

We have thought through a flexible system Supply Columns so you can design the delivery room to suit your current and individual needs

We offer 3 models:

The "Stand-alone" model is mounted in the middle of the room.

The model "Wall mounted" is mounted against the wall.

The model "Wall hung" can be hung on the wall.



Wall mounted

Wall hung

Stand alone

For example, you can place the Supply Column on or against a wall and pull the Birth Pool into a corner or leave it parallel to the Supply Column.

You can also place the Supply Column free standing in the room, ensuring 360 degrees of freedom of movement around the Birth Pool. There is almost no limit.



When choosing the location of the Birth Pool, you should consider how you want any evacuation situation to be handled. Safety around the Birth Pool also requires space. Therefore, place the Birth Pool with the head end pointing into the room so that a bed/stretcher can be placed up against the Birth Pool's slide/back.

EVACUATION SAFETY

When you need to act urgently

Fortunately, the vast majority of births occur without complications. The majority of persons giving birth will be able to actively assist in getting out of the pool if complications arise during labour. Should an emergency occur suddenly, and you need to evacuate the person in labour from the pool, we have designed it to make the situation safer for you.

Using the back of the Birth Pool as a slide, two people can pull the person giving birth up and onto a bed located at the Birth Pool's head end.

The gliding effect and buoyancy of the water help make this manoeuvre feel surprisingly easy. If space is limited in the delivery room, you can also get out from the side of the pool.

The rounded edges of the pool do not harm the person during evacuation.

You can evacuate a person from the Birth Pool immediately if necessary.

Do not drain the pool. The property of water helps the process and is time saving when the person is pulled on to a bed.

You can also use an evacuation net, a stretcher or a hoist.

Call your colleagues for support.

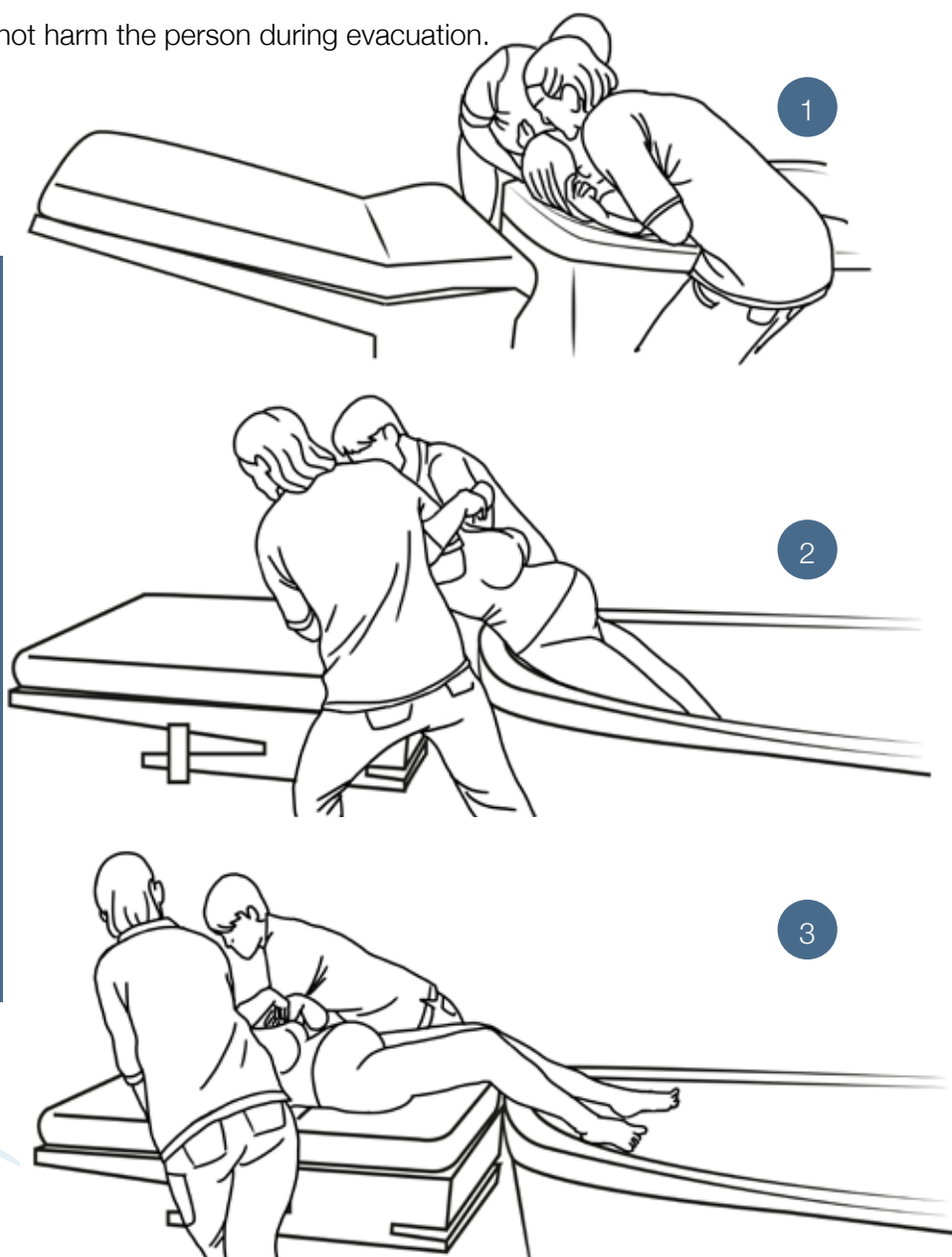

GO THE EXTRA MILE FOR EXCELLENT HYGIENE

Birth Pool with a non-return valve and Legionella filter option. We have developed a Birth Pool with a focus on minimising contaminated bath water

With a FJORDBLINK® Birth Pool, you do not have to worry about contaminated water flowing back from the drain and into the Birth Pool. We have built in a non-return valve in the Birth Pool and Supply Column to prevent this. So you can safely top up with clean, warm water during the birth without the risk from happening of backflow of dirty water.

For extra safety, you can purchase an integrated legionella filter for the Supply Column that removes legionella bacteria from the water that is filled into the Birth Pool via the Supply Column.

In general, infections harming the person giving birth or the baby caused by pathogens in bath water are fortunately rare if adequate hygiene standards are maintained during water births.



- No risk of backflow of contaminated water
- Opportunity for Legionella filter
- The drain can be disinfected
- An unbroken surface and therefore easy and safe to clean

SIMPLE AND SAFE CLEANING AND MAINTENANCE

You can feel safe using this product

The Birth Pool is moulded in resistant medical acrylic reinforced with fibreglass. The surface of the Birth Pool is resistant to disinfectants and easy to clean.

The surface of the Birth Pool is complete and unbroken by mounted parts and is therefore easily and safely cleaned.

Once you have purchased a FJORDBLINK® Birth Pool, we will be happy to guide you through the recommended cleaning process that best suits your maternity ward or maternity clinic.

All detachable of the Supply Column can be disassembled and disinfected in an industrial washing machine or in an autoclave.

Detachable parts such as water supply hoses, hand shower, quick-filler and drain hose are fitted with a quick-connect system that can be operated without the use of tools. Therefore, the parts can be easily dismantled by hand.



Quick-connect system ensures that detachable parts such as:

- Water supply hoses
 - Drain hose
 - Hand shower
 - Quick filler
- ...are easily disassembled without use of tools.



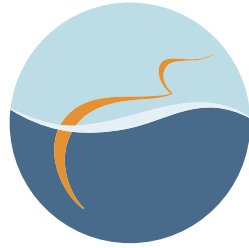

FJORDBLINK

Welcoming Water



FACTS

FJORDBLINK® Medical has in cooperation with Danish midwives developed the FJORDBLINK® Birth Pool, giving You the possibility to support safe labor in water. The pool has been used with good results for more than two decades in several countries.

FJORDBLINK Medical ApS

Ringvejen 2A · DK-9560 Hadsund
+45 40 740 523 · +45 83 840 523
post@fjordblink.com
www.fjordblink.com